



**SECTION III**

**TECHNICAL REFERENCE**



### General Specifications

Model	1G	2G	3G	5G	8G	10G
Impact Class	150	200	500	750	1200	2000
Working Weight	135#	242#	425#	648#	944#	1610#
Carrier Tonnage	1~2	1.5~3	2~4	4~6	6~9	8~12
Length	37"	44.5"	51"	60"	67"	82"
Bracket Type	Top	Top	Top	Top	Top	Top
Bracket Width	7.50"	7.75"	10.75"	10.75"	10.75"	Adjustable
Oil Flow, GPM	2.5	4~8	6.5	8~18	12~23	19~24
Oil Pressure, PSI	1425~1700	1400~1700	1565~1850	1700~1900	1850~2250	2250~2750
Variable Impact Rate	700~1500	650~1500	550~1200	400~900	400~800	400~900
Hose Size HP	1/2"	1/2"	1/2"	1/2"	3/4"	3/4"
Hose Size LP	1/2"	1/2"	1/2"	1/2"	3/4"	3/4"
Valve Adjuster Turns	¾ - 1 ¼	1 ½ - 2	1 ¾ - 2 ¼	1 ¼ - 1 ¾	2 - 2 ½	2 - 2 ¼

### Working Steel Specifications

Model	1G	2G	3G	5G	8G	10G
Tool Diameter	1.50"	1.75"	2.50"	3.00"	3.50"	4.25"
Tool Extension	10.00"	12.25"	13.75"	16.00"	18.25"	26.25"
Blunt Tip #	K12309	K12222	K10693	K10546	K11035	K10935
Moil Point #	K12310	K12223	K10694	K10547	K11036	K10936
Chisel Bit #	K12311	K12221	K10695	K10548	K11037	K10937

### Bolt Torque Specifications (in FOOT/POUNDS)

Model	1G	2G	3G	5G	8G	10G
Through Bolts	180	220	220	360	480	870
Accumulator	140	140	140	180	255	435
Valve Bolts	---	---	---	---	---	250
Cross Bolts	215	250	250	325	725	1230



### General Specifications

Model	10G HD	15G	20G	30G	40G	50G
Impact Class	2500	3000	4000	5000	7000	10000
Working Weight	2200#	2767#	3819#	4393#	5750#	8400#
Carrier Tonnage	10~14	13~18	18~25	25~32	32~44	44+
Length	86"	86"	103"	112"	118"	136"
Bracket Type	Top	Top	Top	Top	Top	Top
Bracket Width	13.00"	15.00"	17.00"	17.00"	17.00"	19.75"
Oil Flow, GPM	19~24	24~32	33~40	39~50	50~65	66~85
Oil Pressure, PSI	2250~2750	2150~2550	2275~2550	2275~2550	2275~2550	2275~2550
Variable Impact Rate	400~900	400~900	400~900	300~600	300~600	250~500
Hose Size HP	3/4"	1"	1"	1"	1-1/4"	1-1/4"
Hose Size LP	3/4"	1"	1"	1"	1-1/4"	1-1/4"
Valve Adjuster Turns	2 - 2 ¼	2 ½ - 3	5 ¼ - 5 ¾	5 ¾ - 6 ¼	3 ½ - 4	3 ¾ - 4 ¼

### Working Steel Specifications

Model	10G	15G	20G	30G	40G	50G
Tool Diameter	4.25"	4.75"	5.25"	6.00"	6.25"	7.00"
Tool Extension	26.25"	26.25"	30.25"	30.75"	32.75"	34.75"
Blunt Tip #	K10935	K11235	K11735	K11335	K11435	K12500
Moil Point #	K10936	K11236	K11736	K11336	K11436	K12501
Chisel Bit #	K10937	K11237	K11737	K11337	K11437	K12502

### Bolt Torque Specifications (in FOOT/POUNDS)

Model	10G	15G	20G	30G	40G	50G
Through Bolts	870	1200	1800	2500	3200	3900
Accumulator	435	500	500	760	760	760
Valve Bolts	250	290	290	250	250	440
Cross Bolts	1230	1800	3200	3200	3200	3200



### Common Replacement or Rebuild Parts

Model	1G	2G	3G	5G	8G	8G
Diaphragm	K12352	K12253	K10557	K10557	K11028	K11028
Seal Kit (Super II)	K12356	K12260	K10660	K10560	K11033	K11033
Seal Kit (Series I)	---	---	---	---	---	---
Front Cover	---	---	---	---	---	---
Thrust Bushing	---	---	---	---	---	---
Thrust Ring	---	---	---	---	---	---
Front Bushing	K12338	K11237	K10643	K10542	K11017	K11017
Underwater Kit	---	---	---	---	---	---
Accumulator Wrench	K18439	K18440	K18440	K18440	K18442	K18442
Wrench Pins	K18446	K18446	K18446	K18446	K18447	K18447
Hose Whips	K12374	K10581	K10581	K10581	K10490	K10490
One Piece QA Bracket	---	---	K15875	K15875	K10490	K10490
Two Piece QA Bracket	---	---	K15555	K15555	---	---

Model	10G	15G	20G	30G	40G	50G
Diaphragm	K10955	K11255	K11755	K11755	K11455	K12566
Seal Kit (Super II)	K10980	K12060	K11848	K10344	K12480	K12570
Seal Kit (Series I)	K10860	K11280	K11780	K11380	K11480	
Front Cover	K10928	K11228	K11728	K11328	K11428	K12543
Thrust Bushing	K10930	K11230	K11828	K11330	K11430	K12545
Thrust Ring	K10931	K11231	K11829	K11331	K11651	K12546
Front Bushing	---	---	---	---	---	---
Underwater Kit	---	KBM21800		KBM21466		---
Accumulator Wrench	K18441	K18441	K18443	K18443	---	---
Wrench Pins	K18448	K18448	K18448	K18448	---	---
Hose Whips	K10981	K12381	K12381	K12381	K12481	---
One Piece QA Bracket	---	---	---	---	---	---
Two Piece QA Bracket	---	---	---	---	---	---



### Hydraulic Compactor Specifications

Model	KHP30	KHP65	KHP135	KHP210
Impulse Class	300#	6000#	13,500#	20,000#
Working Weight	350	790	1350	2100
Carrier Tonnage	6~9	8~12	13~18	18~25
Width	12"	24"	28"	34"
Height	20.50"	26.25"	33.86"	39.12"
Bracket Width	10.25"	10.75"	14.50"	17.00"
Base Plate Dimensions	12" x 26"	24" x 34"	28" x 40"	34" x 46"
Oil Flow, GPM	7.5	16	30	48
Oil Pressure, PSI	2000	2000	2000	2000
Cycles per Minute	2000	2000	2000	2000
Hose Size (IN & OUT)	½" & ½"	¾" & ¾"	¾" & 1"	1" & 1 ¼"

### Noise (dba) Level of Kent KHB Hammers

<i>Distance (Meters)</i>	<i>Distance (Feet)</i>	1G	2G	3G	5G	8G	10G	15G	20G	30G	40G	50G
<b>1.6</b>	<b>5.3</b>	98	100	101	104	105	110	111	112	113	114	116
<b>3.3</b>	<b>10.7</b>	92	94	95	98	99	104	105	106	107	108	110
<b>7.5</b>	<b>24.6</b>	86	88	89	92	93	98	99	100	101	102	104
<b>15.0</b>	<b>49.2</b>	80	82	83	86	87	92	93	94	95	96	98
<b>30.0</b>	<b>98.4</b>	74	76	77	80	81	86	87	88	89	90	92
<b>60.0</b>	<b>196.9</b>	68	70	71	74	75	80	81	82	83	84	86
<b>120.0</b>	<b>393.7</b>	62	64	65	68	69	74	75	76	77	78	80
<b>240.0</b>	<b>787.4</b>	56	58	59	62	63	68	69	70	71	72	74

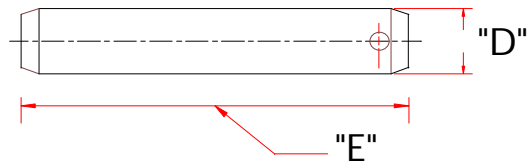
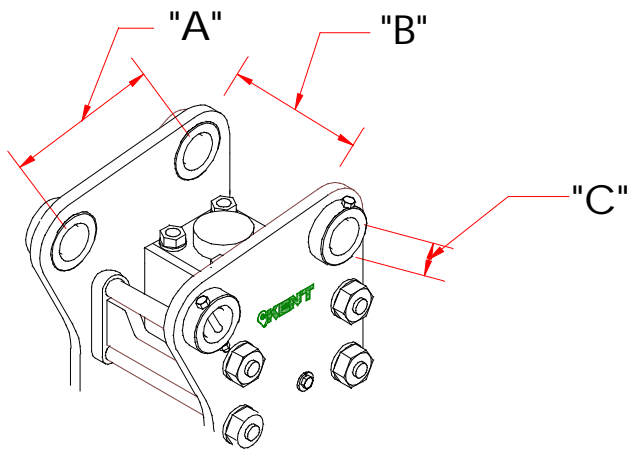

- "A" = Pin Center to Center
- "B" = Nominal Inside Spacing
- "C" = Bushing Hole Diameter
- "D" = Maximum Pin Diameter
- "E" = Standard Pin Length

Model	"A"	"B"	"C"	"D"	"E"
KHP65	14.00"	10.25"	2.50"	2.5"	17.0"
KHP135	19.50"	15.00"	4.50"	4.0"	24.0"
KHP210	19.50"	16.50"	4.50"	4.0"	26.0"
KHB1G	6.00"	7.50"	2.00"	2.0"	12.0"
KHB2G	8.00"	7.50"	2.00"	2.0"	12.0"
KHB3G	14.00"	10.75"	2.50"	2.5"	17.0"
KHB5G	14.00"	10.75"	2.50"	2.5"	17.0"
KHB8G	14.00"	10.75"	2.50"	2.5"	17.0"
KHB10GH	18.15"	13.00"	3.50"	3.0"	22.0"
KHB15G	19.50"	15.00"	4.50"	4.0"	24.0"
KHB20G	19.50"	17.00"	4.50"	4.0"	26.0"
KHB30G	19.50"	17.00"	4.50"	4.0"	26.0"
KHB40G	19.50"	17.00"	4.50"	4.0"	26.0"
KHB50G	23.58"	20.25"	5.50"	5.0"	30.0"